

\$77,500 - Park Street N, Rural Forty Mile No. 8, County of

MLS® #A2149700

\$77,500

0 Bedroom, 0.00 Bathroom,
Land on 1.45 Acres

Winnifred, Rural Forty Mile No. 8, County of,
Alberta

Looking to get your very own little prairie oasis? Then come on out to Winnifred and check out the land that's available for sale! 10 minutes from Bow Island with all the town amenities including Tim Horton's! The county has plumbed water to all the properties in Winnifred as well. Call your favorite REALTOR® today and book your very own private viewing!

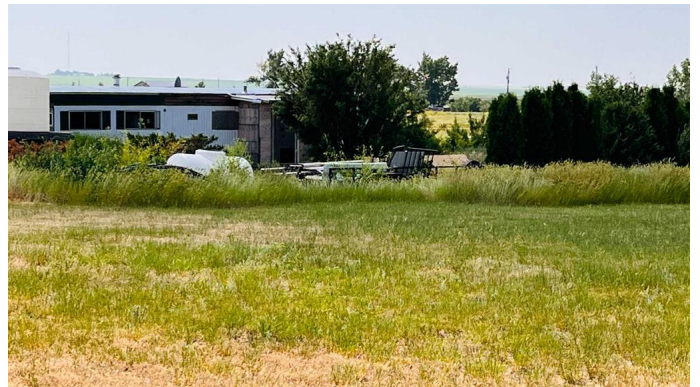
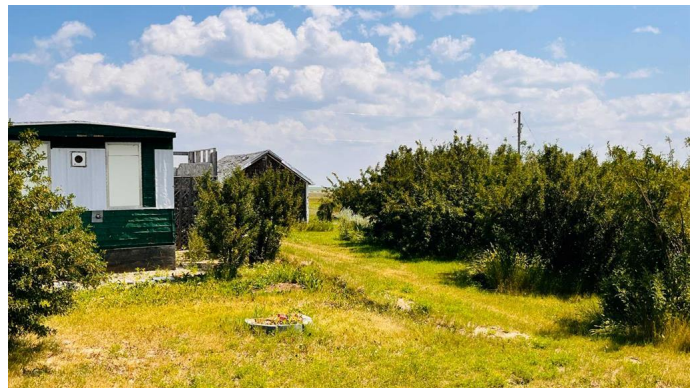

Essential Information

MLS® #	A2149700
Price	\$77,500
Bathrooms	0.00
Acres	1.45
Type	Land
Sub-Type	Residential Land
Status	Active

Community Information

Address	Park Street N
Subdivision	Winnifred
City	Rural Forty Mile No. 8, County of
County	Forty Mile No. 8, County of
Province	Alberta
Postal Code	T0K 0G0

Amenities

Amenities None

Exterior

Lot Description Back Lane, Back Yard, Front Yard, Interior Lot, Open Lot, Standard Shaped Lot, Views

Additional Information

Date Listed July 12th, 2024

Days on Market 281

Zoning Residential

Listing Details

Listing Office Real Estate Centre - Bow Island

Data is supplied by Pillar 9â„¢ MLSÂ® System. Pillar 9â„¢ is the owner of the copyright in its MLSÂ® System. Data is deemed reliable but is not guaranteed accurate by Pillar 9â„¢. The trademarks MLSÂ®, Multiple Listing ServiceÂ® and the associated logos are owned by The Canadian Real Estate Association (CREA) and identify the quality of services provided by real estate professionals who are members of CREA. Used under license.