

# \$3,900,000 - 4;25;24;26 Se Strathmore

244046 Rge Rd 251,

MLS® #A2108975

**\$3,900,000**

0 Bedroom, 0.00 Bathroom,  
Land on 79.50 Acres

NONE, Strathmore, Alberta

Located within the Town of Strathmore, a rare opportunity to own approximately 80 acres for future development. Town of Strathmore has an Area Structure Plan available.



## Essential Information

|           |                  |
|-----------|------------------|
| MLS® #    | A2108975         |
| Price     | \$3,900,000      |
| Bathrooms | 0.00             |
| Acres     | 79.50            |
| Type      | Land             |
| Sub-Type  | Residential Land |
| Status    | Active           |

## Community Information

|             |                          |
|-------------|--------------------------|
| Address     | 4;25;24;26 Se 244046 Rge |
| Subdivision | NONE                     |
| City        | Strathmore               |
| County      | Wheatland County         |
| Province    | Alberta                  |
| Postal Code | T1P 0P1                  |

## Additional Information

|                |                     |
|----------------|---------------------|
| Date Listed    | February 26th, 2024 |
| Days on Market | 417                 |
| Zoning         | GA                  |

## Listing Details

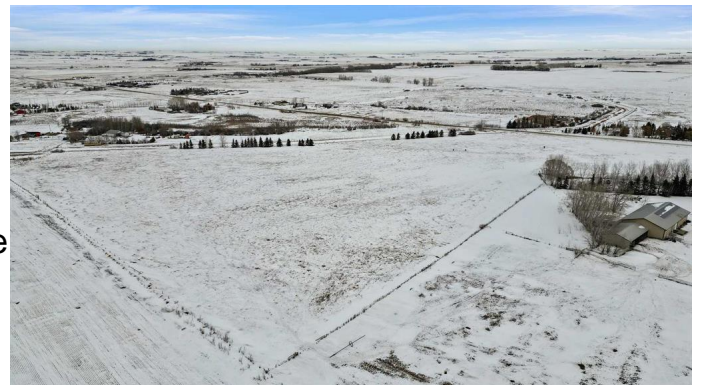

Listing Office

CIR Realty

Data is supplied by Pillar 9â„¢ MLSÂ® System. Pillar 9â„¢ is the owner of the copyright in its MLSÂ® System. Data is deemed reliable but is not guaranteed accurate by Pillar 9â„¢. The trademarks MLSÂ®, Multiple Listing ServiceÂ® and the associated logos are owned by The Canadian Real Estate Association (CREA) and identify the quality of services provided by real estate professionals who are members of CREA. Used under license.